

Regional Primary FRCA Study Day: **Endocrine Physiology and Pharmacology: Adrenal, Thyroid and Pancreas**

Post Graduate Medical and Dental Education Centre
The Queen Elizabeth Hospital King's Lynn
November 14th 09:00–16:00

Programme

09:00 Welcome

09:10 Lecture: Thyroid physiology

09:40 Lecture: Thyroid pharmacology

10:10 Lecture: Adrenal physiology

10:40 Coffee

11:10 Lecture: Adrenal Pharmacology

11:40 Lecture: Pancreatic physiology

12:10 Lecture: Pancreatic pharmacology

12:40 Lunch

13:40 MCQ and SBA session to revise and consolidate knowledge

16:00 Close

Our intention is that the MCQs/ SBAs session consolidates the knowledge gained during the day. Should anyone wish to have some SOE practice we can arrange it on the day.

The lecture topics have been chosen having asked Primary FRCA examiners for topics that are traditionally answered badly in the exam.

Please contact the department to let us know if you are coming or if you have any questions: Beverly.Mussett@gehkl.nhs.uk

Unfortunately we can no longer arrange for free car parking on site. Sorry.

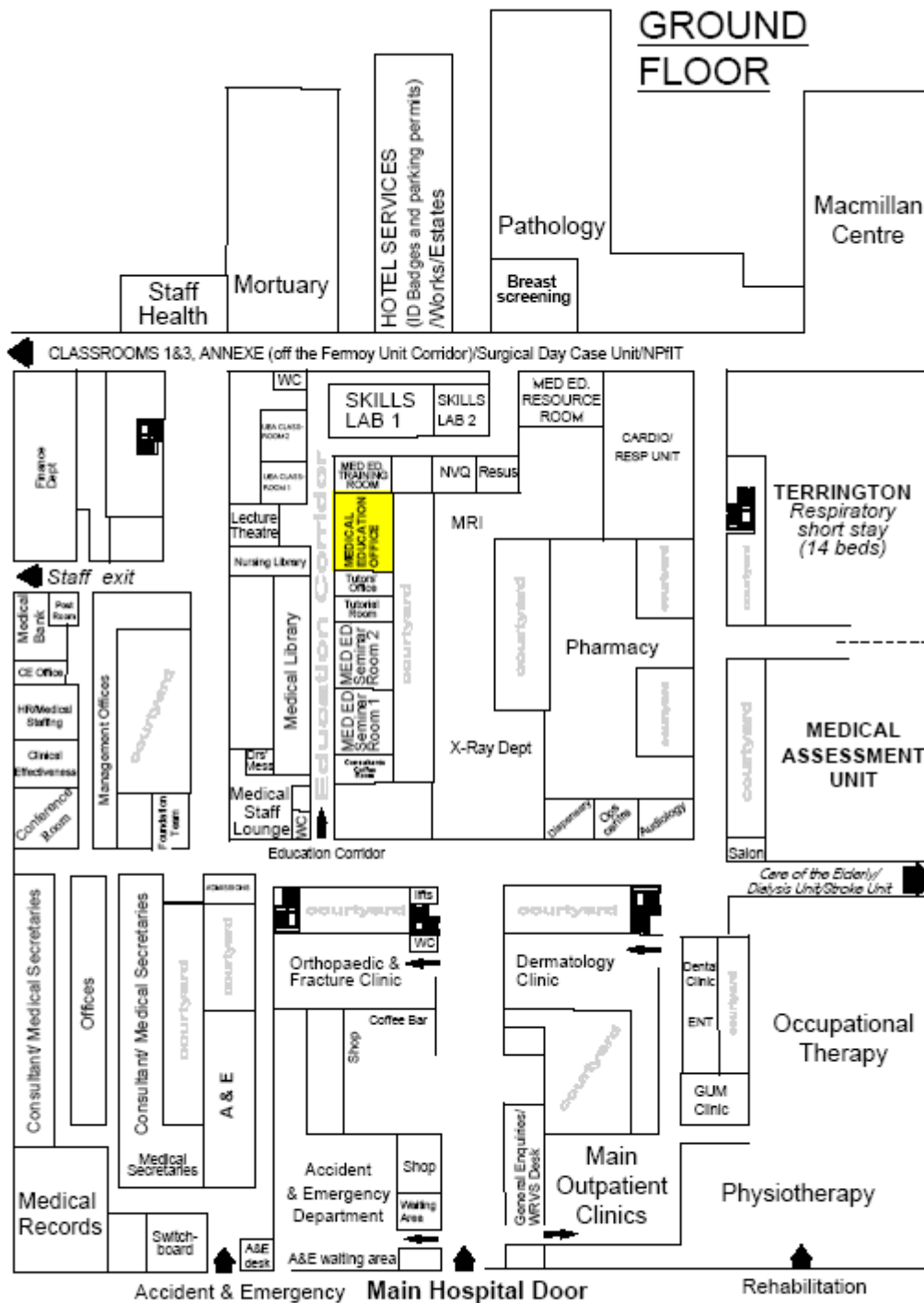

(PGME/ Centre 26/9/2008)

The Queen Elizabeth Hospital
 Gayton road, King's Lynn
 Norfolk PE30 4ET
 Tel: 01553 613791

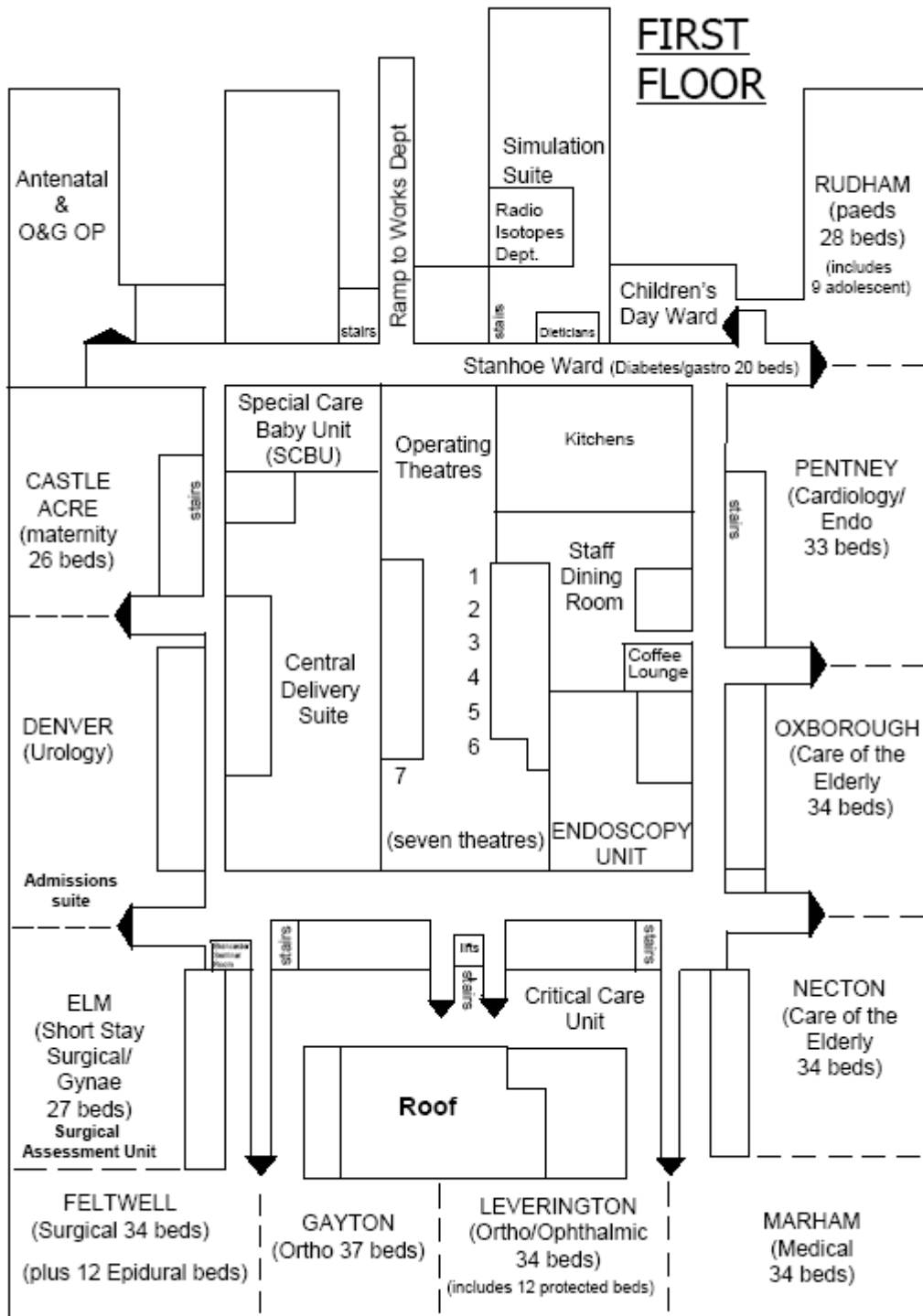

(PGME Centre 23/11/2009)

The Queen Elizabeth Hospital
 Gayton road, King's Lynn
 Norfolk, PE30 4BT
 Tel: 01553 613791

QUEEN K.L.

BUS PARKING & LAY BY (Red Line)

2020

South Road

